

SAW Resonator D02

315.00 / 433.92MHz



It is a true one-port SAW resonator in a low profile TO39 case. This product is designed for remote control and wireless security transmitters.

FEATURES

- One-port resonator
- Fundamental Mode
- Quartz Stabilization

Electrical Specifications

Parameter	Symbol	Condition	Typical			Units
Frequency Range	F_0		315.00 / 433.92			MHz
Frequency Tolerance	$\Delta F/F_0$	at 25°C	±50		±500	KHz
Temperature Stability	T_C	Ref to 25°C		-0.032		PPM/(°C) ²
Operating Temperature Range	T_{OPR}		-40	-10 to +60	+85	°C
Storage Temperature Range	T_{STG}		-40		+85	°C
Shunt Capacitance	C_0				4	pF
Insertion Loss	I_L				3	dB
Motional Resistance	R_M				50	Ω
Quality Factor (unloaded)	Q_U		8,000		20,000	
Aging (First year)	F_a	at 25°C	-10		+10	PPM

Mechanical Dimensions

D02(TO-39/3A) (mm)

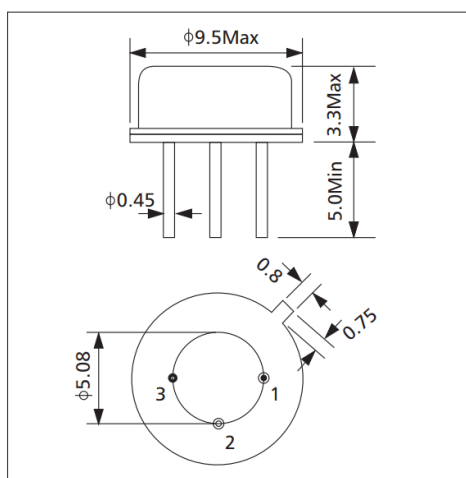

D02(TO-39/3A) (inch)

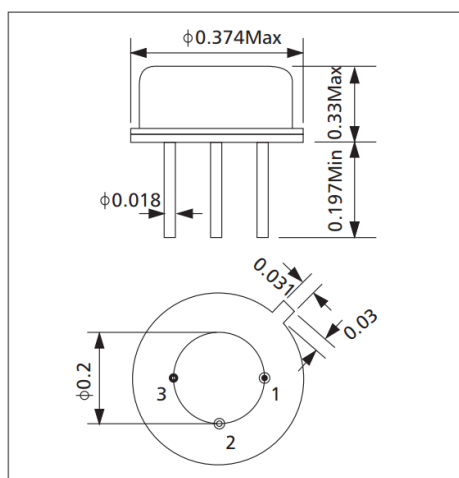

Pin	Connection
1	Input / Output
2	Input / Output
3	GND