

## LEDs

### 5050 SMD – RGB – Left Anode

HL-9564

#### Package Configuration

Descriptions:
Emitting Color: RGB
Device Outline: 3.4x3.3x1.8mm
Lens Type: Water Clear

Pin	Description
A1	Anode (Red)
C1	Cathode (Red)
A2	Anode (Green)
C2	Cathode (Green)
A3	Anode (Blue)
C3	Cathode (Blue)

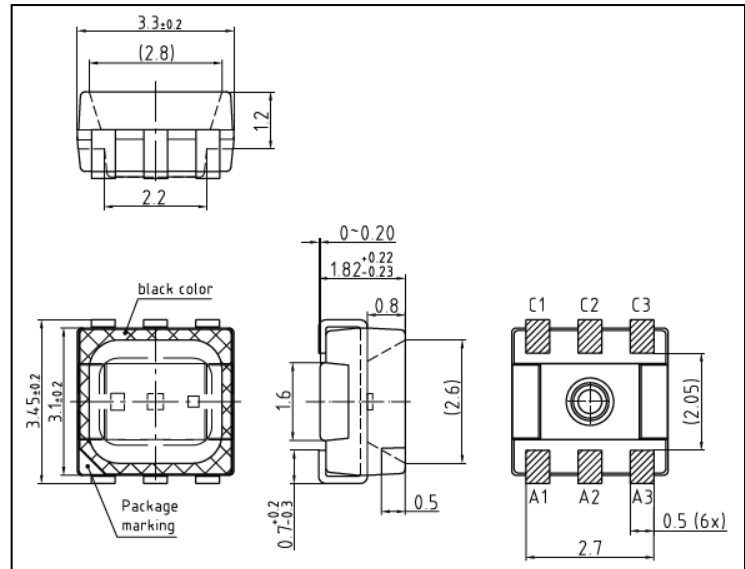

### Absolute Maximum Ratings (T<sub>a</sub>=25°C)

Parameter	Max.	Unit.
Peak Forward Current (1/10 Duty Cycle, 0.1ms Pulse Width)	100	mA
Continuous Forward Current	(3x20)	mA
Reverse Voltage	5	V
Storage/Operating Temperature Range	-40 °C to +85°C	
Power Dissipation	100mW	
Lead Soldering Temperature[4mm(.157") From Body]	250°C for 5 Seconds	

### Electrical and optical characteristics

Parameter	Symbol	Typ.	Unit.	Test Condition
Luminous Intensity	I <sub>v</sub>	R=800 / G=1900 / B=400	mcd	I <sub>F</sub> =60mA (3x20mA)
Viewing Angle	2θ <sub>1/2</sub>	120	deg.	
Dominant Wavelength	λ	R=621 / G=532 / B=465	nm	
Forward Voltage	V <sub>F</sub>	R=2.1 / G=2.7 / B=2.9	V	