

LEDs

5050 SMD – RGB – Left Anode

HL-7934

Descriptions:

Emitting Color: RGB

Device Outline: 5.0x5.0x1.6mm

Lens Type: Water Clear

Package Configuration

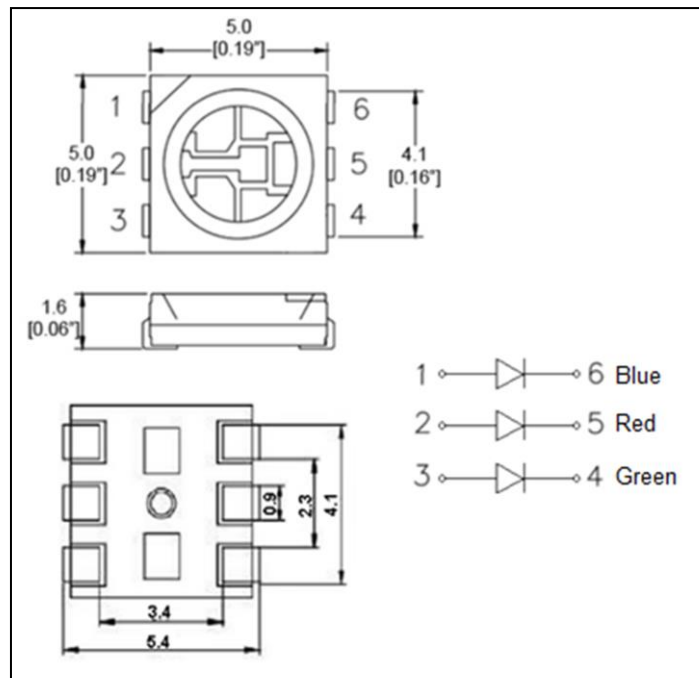

Absolute Maximum Ratings ($T_a=25^\circ\text{C}$)

Parameter	Max.	Unit.
Peak Forward Current (1/10 Duty Cycle, 0.1ms Pulse Width)	200	mA
Continuous Forward Current	60 (3x20)	mA
Reverse Voltage	5	V
Storage/Operating Temperature Range	-40 °C to +85°C	
Power Dissipation	170mW	
Lead Soldering Temperature[4mm(.157") From Body]	250°C for 5 Seconds	

Electrical and optical characteristics

Parameter	Symbol	Typ.	Unit.	Test Condition
Luminous Intensity	I_v	R=400 / G=800 / B=200	mcd	$I_F=60\text{mA}$ (3x20mA)
Viewing Angle	$2\theta_{1/2}$	120	deg.	
Dominant Wavelength	λ_d	R=625 / G=520 / B=465	nm	
Forward Voltage	V_F	R=2.0 / G=3.2 / B=3.2	V	